



carpentier
SMART WOOD FOR NICE PLACES

Concepts

Handy kits for quick installation

Kits for professional use

Carpentier supplies fully finished wood constructions in smart, ready-made kits designed especially for professional use. Naturally, our products meet the highest quality standards. And thanks to the instructions that come with each kit, installation is always quick and easy.

CNC machines in our own workshop

We use our own computer-driven CNC machines to ensure that each project is prepared accurately, down to the smallest detail.

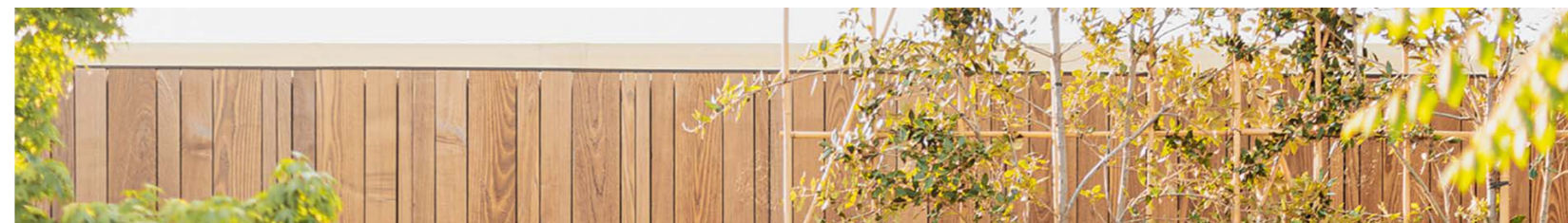

Wooden outbuildings	4
Simple installation	5
Made-to-measure kits	7
Carpentier app	8

Wooden gates	10
Sliding gates	11
Swing gates	12
Garden gates	13
Finish and accessories	14
Installation	15

Wooden sun shades	16
Louvered pergolas	17
Side elements for a louvered pergola	18
Wooden shutters	19
Room divider	21
Horizontal slat awning	21

Wooden fences	22
Installation	23
Finish	24

Timber-frame construction	26
----------------------------------	-----------





Wooden outbuildings

Carpentier designs, builds and supplies fully finished wooden outbuildings in smart ready-made kits. Every kind of annex can be built entirely made-to-measure in all styles, from streamlined and modern to traditional and rustic. Each kit comes with technical plans that will enable a professional builder to construct them in no time.

OUR GREATEST ASSETS

- Modern designs
- High-quality, sustainably sourced materials
- Wide assortment of wood varieties and finishes
- Tailor-made designs
- Design app enabling 3D visuals and calculations of prices
- Ready-made kits that include doors, windows, door and window hardware and installation materials
- Rapid installation using our simple click systems
- Seamless perfection thanks to our QuickClip® profiles with hidden Grad® installation system
- Complete concepts also available for outbuildings, gates and fencing in the same style and wood



Simple installation

Carpentier stands for design and innovation, and our smart building systems are a perfect example of both. Our outbuildings come in practical, **ready-made kits** that we create entirely in our own workshop on our CNC machines. Every detail is already in place, so constructions come together perfectly, piece by piece, at the site. With **numbered parts** and a **technical plan** provided, assembly couldn't be easier. And thanks to the Grad® installation system, applying QuickClip® cladding is fast and easy too.



Made-to-measure kits

Carpentier is your specialist for wooden outbuildings. We create tailor-made outbuildings which we supply as **ready-to-assemble kits**. Working together with you, we can build on an existing sketch or develop a plan from scratch using our handy app. Moreover, the app enables us to produce a visual representation of the finished outbuilding and estimate the required budget. When necessary we can also call in the services of an external architect. Once the plans are ready, we get to work on a smart construction kit for the outbuilding, whether it is a pool house, carport, garden building or pergola.

We craft each outbuilding in our own workshop with an eye for detail, so pieces come together like a puzzle on site. All of our materials are of the highest quality, and an outstanding finish is guaranteed. Moreover, each piece is numbered and all kits come with assembly instructions and technical drawings. In combination with our smart installation systems, this is everything you need for easy assembly.





Design your own, bespoke, wooden outbuilding

ADVANTAGES OF OUR APP

- Quick calculations
- Immediate visualisations
- 3D rendering & VR options
- Desktop app that our dealers can use to adapt designs
- Instant material take-off
- Quick insight into energy performance and other energy-efficiency tools
- Accurate representation of natural light and shadow
- Useful functions for building permit applications
- Suitable for wooden outbuildings, gates and timber-frame construction

User-friendly app

Our app is extremely user-friendly and requires no prior knowledge of design programmes. After training from one of our sales staff to help you master the finer points of the app, you will be able to start using it right away.

In just a few steps, you can bring your client's wooden outbuilding to life. Whether it is a pool house, carport, garden shed, conservatory or extension, you can design it and add any option you like. It is just as simple to add the finishes of your choice.

For an even more realistic picture you can add in your existing garden and plan the interior design of your outbuilding. You will not miss a single detail.

Receive a quote immediately

The app is a convenient tool for designing and previewing wooden outbuildings. It also enables you to quickly estimate the price of a construction. Send your design to us with just a single click, and we will provide you with a quote in no time. This means that you can provide your customer with information immediately, and then make adjustments if necessary.

Ready to get started? Request the Carpentier app manual and terms of use now.



An impressive way to determine the required finish and price. The app produces an on-the-spot quote and corresponding 3D images.

— Kevin Mampay, Make Concepts



Discover the unique advantages of our app in our online video:





Wooden gates



Carpentier designs and builds beautiful aluminium framed sliding and swing gates with cladding in a wide range of sustainable wood varieties such as HOTwood ash, HOTwood pine, HOTwood clear pine, oak and barnwood. Various options exist for finishes and accessories, even for our standard models. Every gate is delivered to the customer fully finished and mounted on a cement foundation. We also supply garden gates as smart, ready-to-assemble kits with detailed instructions for installation by woodworking professionals.

OUR GREATEST ASSETS

- Extremely stable thanks to frame in aluminium
- Highly durable and free of distortion thanks to metal posts, which can also be enclosed in wood
- QuickClip® profiles for seamless cladding, with aluminium joists that ensure invisible installation
- High-quality ball bearings for clean aesthetics, instead of visible hinges
- Extensive assortment of profiles for a harmonious effect
- Gates can be pre-mounted on a concrete foundation, enabling single-day installation
- Quick delivery times for gates in standard designs
- All gates can be easily integrated into our fencing.

Sliding gates

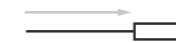

Plus line (QuickClip®) in HOTwood ash with black finish



Plus line (QuickClip®) in HOTwood ash

Standard designs

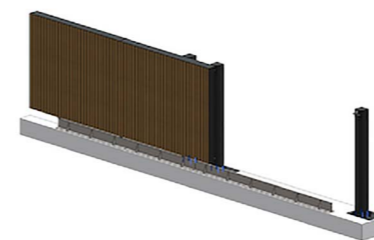

Design A - Duke

Standard height: 1800mm
 Standard widths: 3900 | 4400 | 4900 | 5400 | 5900mm
 Aluminium posts 150x150mm without cladding

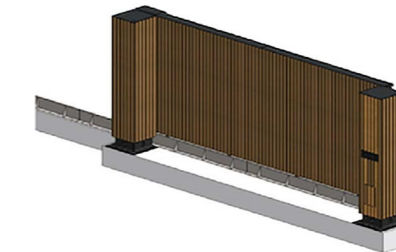

Design B - Queen

Standard height: 1800mm
 Standard widths: 3800 | 4300 | 4800 | 5300 | 5800mm
 Aluminium posts with timber cladding 400 x 400mm
 Optional: integrated letterbox for parcels



Design C - King

Standard height: 1800mm
 Standard widths: 5200 | 5700 | 6200mm
 Aluminium posts with timber cladding 540 x 540mm
 Optional: integrated letterbox for parcels

Besides our range of standard designs, we can also design a tailor-made gate upon request.

Swing gates

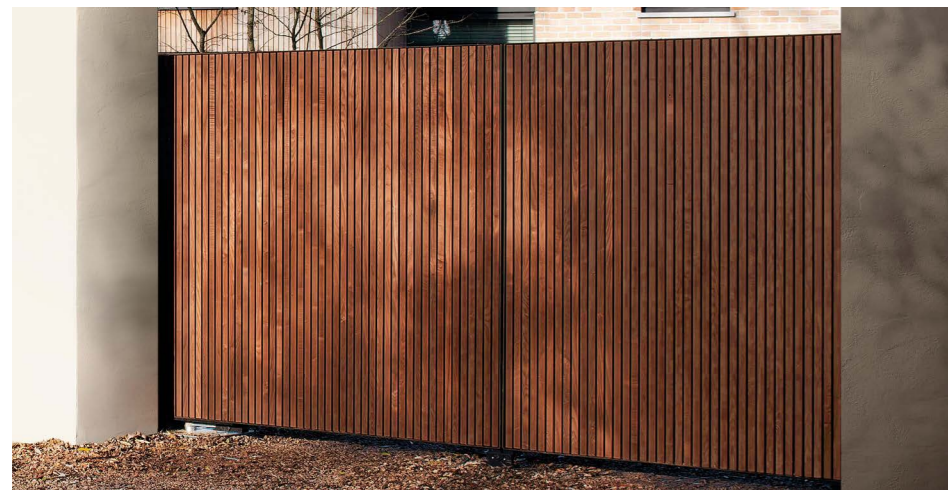

Fine line (QuickClip®) in HOTwood ash

Shiplap (QuickClip®) in charred HOTwood ash

Standard designs

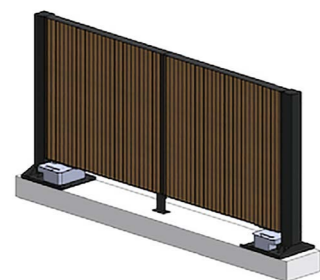

Design A - Duke

Standard height: 1800mm
 Standard widths: 3300 | 3800 | 4000 | 4300mm
 Aluminium posts 150 x 150mm without cladding

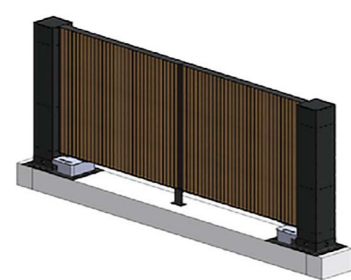

Design B - Queen

Standard height: 1800mm
 Standard widths: 3800 | 4300 | 4800mm
 Aluminium posts with timber cladding 400 x 400mm
 Optional: integrated letterbox for parcels

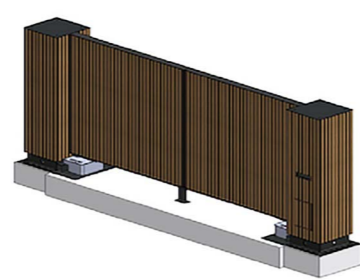

Design C - King

Standard height: 800mm
 Standard widths: 3500 | 4000mm
 Aluminium posts with timber cladding 580 x 580mm
 Optional: integrated letterbox for parcels



Model D - Valet

Standard height: 1800 mm
 Standard widths: 3600 mm (total width: 3900mm)
 Aluminium posts 150 x 150mm without cladding
 Optional: concrete foundation
 In kit

Besides our range of standard designs, we can also design a tailor-made gate upon request.

Garden gates



Plus line (QuickClip®) in HOTwood ash

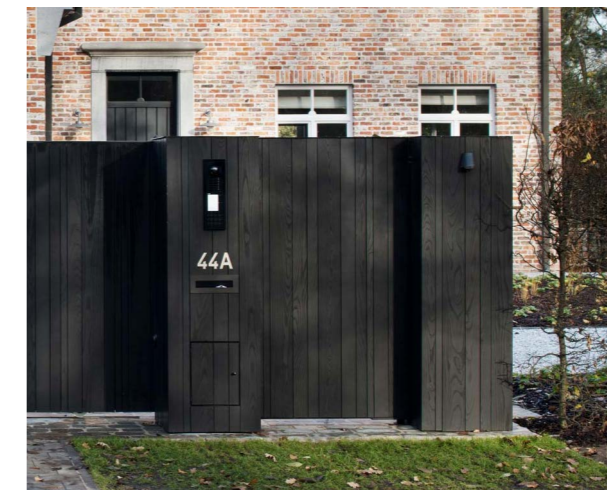

Plus line (QuickClip®) in HOTwood ash with black finish



Shiplap (QuickClip®) in HOTwood ash

Standard designs



Garden gate in fencing

Standard height: 1800mm
 Standard widths: 950mm
 Aluminium posts: 80 x 80mm
 Free-standing installation not possible
 Delivery in ready-made kit



Freestanding garden gate

Standard height: 1800mm
 Standard widths: 950mm
 Aluminium posts: 150 x 150mm
 Delivery in ready-made kit

Besides our range of standard designs, we can also design a tailor-made gate upon request.

Choose from a range of cladding profiles

Rhombus (QuickClip®)

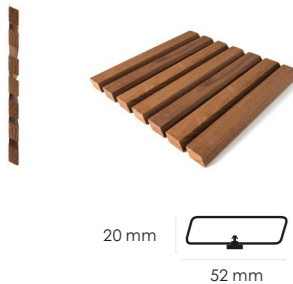

Open line (QuickClip®)



Plus line (QuickClip®)



Consult our Solutions brochure or www.carpentier.be to see more profiles.



All gate types are available in:

HOTWOOD ASH



HOTWOOD PINE



HOTWOOD CLEAR PINE

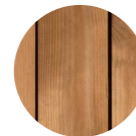

ALUMINIUM



CHARRED WOOD



OAK



BARNWOOD

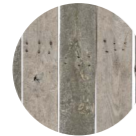

Optional accessories:

VIDEO SURVEILLANCE



KEYPAD



LETTERBOX



LIGHTING



Single-day installation

We assemble our wooden gates in our own workshop, including all of the optional accessories of the customer's choice, and attach them to the concrete base. They are then delivered to the installation location by special transport and lifted into place using a crane. The only on-site preparation required is to dig the hole for the foundation. This plug-and-play solution enables to create a safe entryway to a home or property in just a single day. Another advantage of a prefab wooden gate is that the structure holds itself in place thanks to the foundation.

Watch our online video to see this process in action: www.carpentier.be/en/videos



Wooden sun shades

Besides fully finished HOTwood ash pergolas with motorised louvered roof, Carpentier also offers a range of wooden shutters and side elements in smart ready-made kits. These products provide a uniquely sustainable shade solution with a focus on flexibility and aesthetics.

Louvered roofs

OUR GREATEST ASSETS

- Minimalist designs
- Tailor-made solutions for extensions, upsizing or stand-alone pergolas
- The only motorized louvered pergola in which only wooden parts are visible
- A range of options for side elements, including glass doors and sliding doors, wooden side panels and wooden shutters with adjustable louvers

Wooden shutters

OUR GREATEST ASSETS

- Aesthetics are a priority, so mechanical workings are hidden within the wooden framework
- Can be connected to a smart home system
- Tailor-made designs for patios, interior and exterior windows, and room dividers

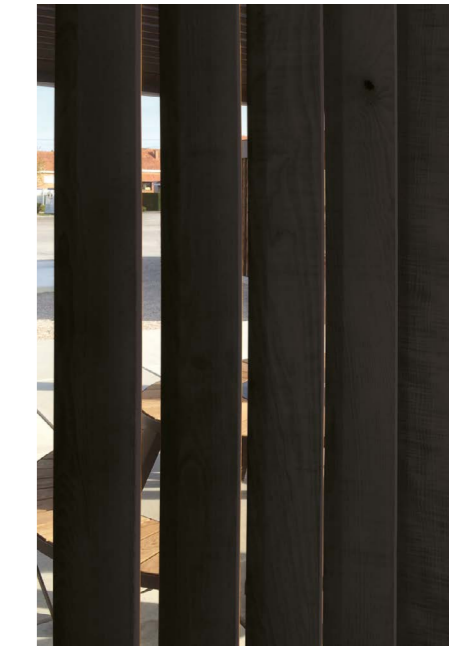
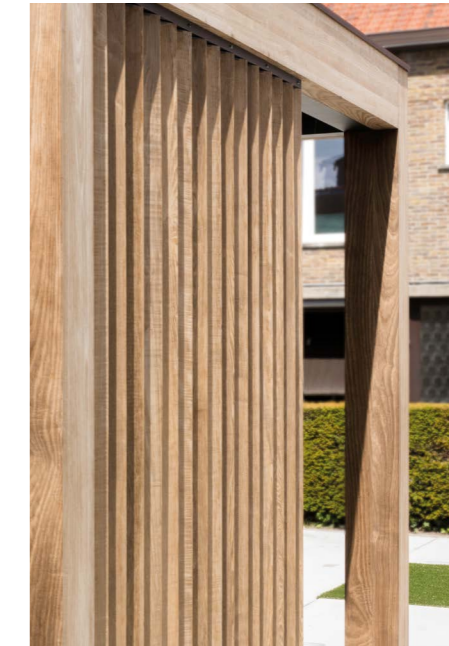

Louvered pergolas



Our modern pergolas feature a motorised louvered roof. Each project is tailor-made for delivery in a **smart ready-made kit**. Professional installation of the minimalist louvered pergola is easy thanks to the instructions provided with each kit, and it can be perfectly integrated into any existing building or extension. Our louvered roof is also ideal for a modern stand-alone pergola.

The adjustable louvers in **HOTwood ash** are embedded in aluminium to ensure **smooth running**.

See our video presentation at:
www.carpentier.be/en/videos



Side elements for a louvered pergola

To extend enjoyment of the garden as long as possible through the season, Carpentier offers a wide range of side elements that can be seamlessly integrated into our stylish louvered pergola or added to an existing aluminium or wooden pergola, patio cover or open veranda. Types can be used together in any desired combination, and they are delivered in smart, **ready-to-assemble kits**.

Watch our online video and discover just how easy it is to install a pergola side panel using our QuickClip® profiles.

Wooden shutter panels with adjustable louvers

To let in a pleasant breeze or a bit of sunlight, our wooden shutters with **vertical or horizontal louvers** are an excellent, ecologically responsible option for creating shelter and privacy underneath a louvered pergola or patio cover. With all mechanical parts hidden in the wooden frame, all you see is the natural beauty of the design. Louvers can be adjusted **manually or automatically**, or even linked to a home automation system.

Side panels in wood

Our high-quality side panels are highly functional, and their **horizontal or vertical lines** add a warm, natural touch to a pergola. Cladding can be added on one or both sides in a QuickClip® profile in HOTwood ash or HOTwood pine.

Wooden shutter panel with adjustable louvers



Side panel in wood



Shutters open



Shutters closed

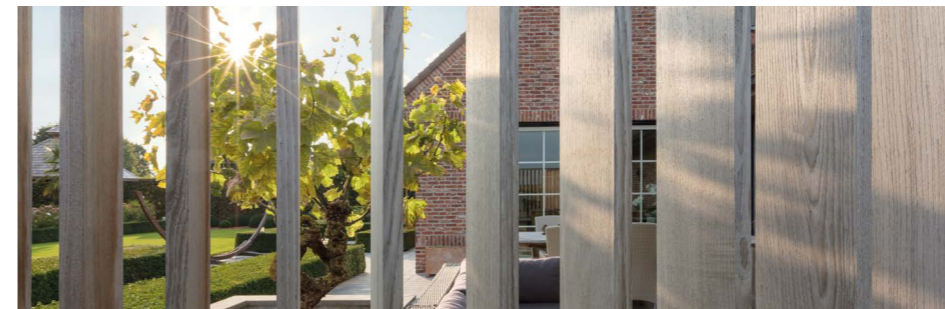

Wooden shutters



Patio shutters

Carpentier's high-quality wooden shutters are an ideal choice for sectioning off an area of garden to create a patio or intimate seating area. Created in HOTwood, they are available with **horizontal and vertical louvers** that can be adjusted exactly as desired. When closed they provide privacy and protection from wind, rain and blinding sun, and when open they allow a clear view of the surroundings. Carpentier provides tailor-designed wooden shutters in **ready-made kits** for professional assembly.

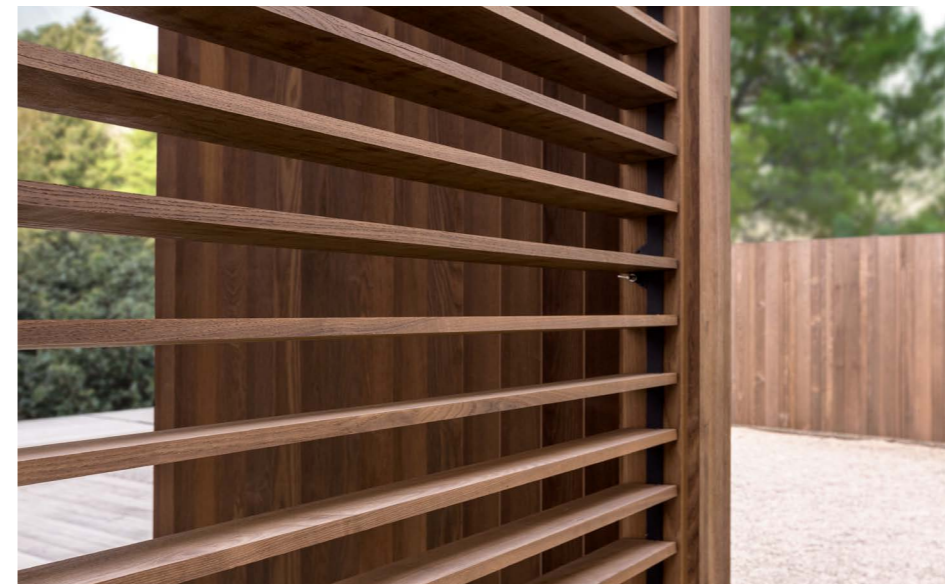



Interior and exterior window shutters

Our sun shades for windows offer control over exactly how much light enters a room. Carpentier has come up with some ingenious solutions for inside or outside windows, and these can be tailored to fit every kind of window too.

Thanks to the many finish options, we have a window shutter to match any house and its architecture. And since the sun shades are delivered in ready-to-use kits, installation takes no time at all.

See our video presentation at:
www.carpentier.be/en/videos



Room divider

Our wooden shutters offer countless interior design possibilities. For example, they are perfect as a **room divider** or for breaking up a large space. Thanks to the movable slats, you can connect or separate spaces to create just the right amount of privacy.

All Carpentier bespoke partitions are made in HOTwood oak or ash. These two, superior quality wood varieties can be finished in a colour to match the rest of the interior. And since the wooden partitions are **delivered in kit form**, they can be assembled quickly and easily.



Horizontal slat awnings

Carpentier designs and creates horizontal slat awnings that can be fitted to **facades**. The fixed wooden slats are made from HOTwood ash and offer an elegant solution when the sun's rays are too strong. What's more, they stop rooms getting too hot in summer. An ecological alternative to air conditioning!

Each horizontal awning is made-to-measure, so you can choose the length, width and finish you want. Delivery in kit form makes the awning easier for a professional to install.



Wooden fences

Carpentier's timber fencing is available in a range of sustainably sourced wood varieties and stylish profiles and countless finishes. We deliver our garden fences made to measure in smart ready-made kits. Moreover, the unique Grad® installation system ensures that fencing will go up quickly and look perfect.

OUR GREATEST ASSETS

- Extremely stable thanks to frame in aluminium
- Highly durable and distortion-free thanks to aluminium posts enclosed in wood
- QuickClip® profiles for seamless cladding, with aluminium joists that ensure invisible installation
- Since posts are invisible, the fencing appears as an unbroken surface
- High-quality ball bearings for clean aesthetics, instead of visible hinges
- Extensive assortment of profiles for a harmonious effect
- Rapid installation

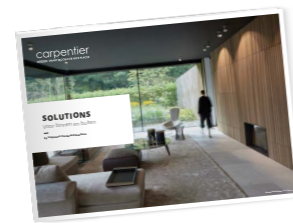

To find out more about our QuickClip® products, request our Solutions brochure or visit www.carpentier.be

Placement

Horizontal cladding system

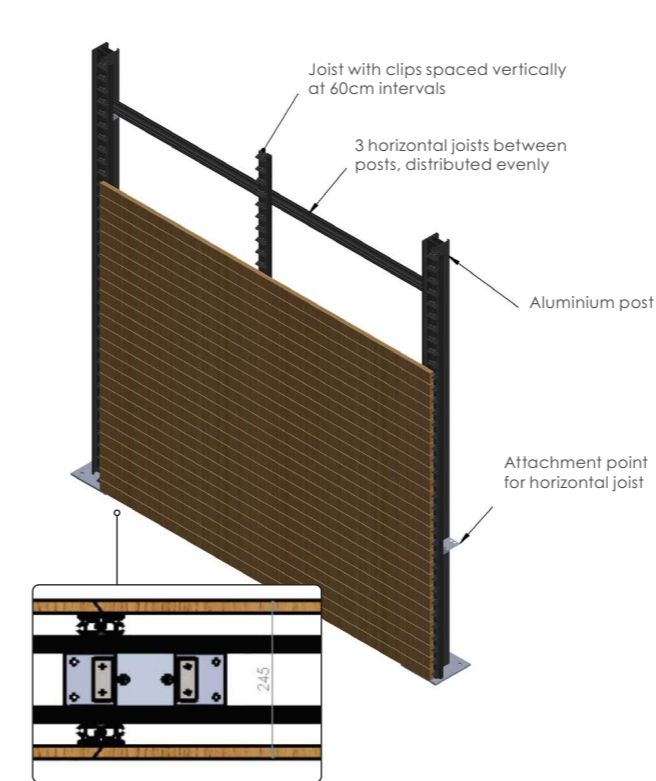

Vertical cladding system

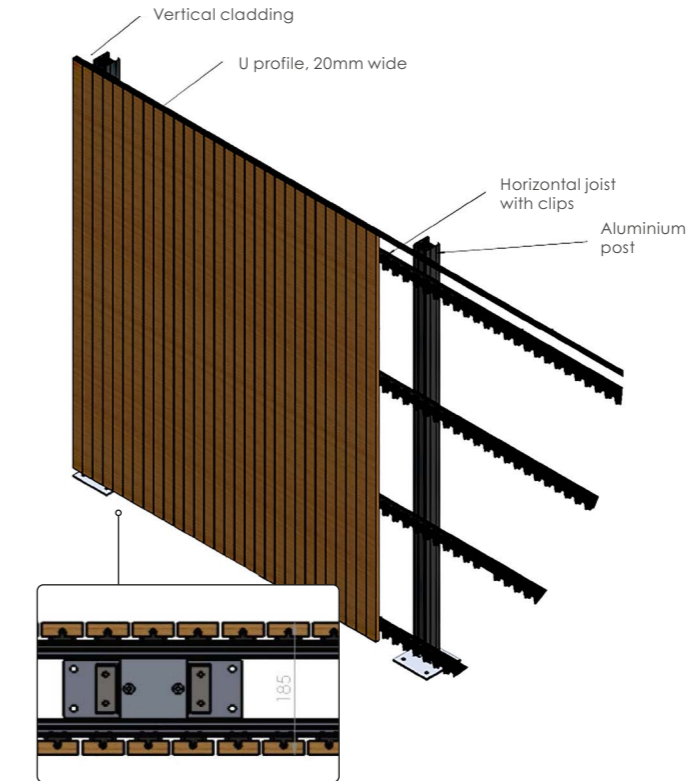

Advice from our wood specialists:

If posts cannot be driven into the ground, for example due to the presence of a deck, a stainless steel base can be affixed to the deck and posts positioned on base feet.

QuickClip® profiles are used as cladding for our fencing. Thanks to the invisible Grad® installation system, seamless results are guaranteed.

Good to know: clips are attached to joists prior to installation at precisely the right spacing. This means that the builder can get started right away, since all he has to do is click the wooden boards in place.

- Invisible installation
- Quick, efficient installation: reduces costly installation bills by up to **50%**
- Splinter-free: no screws or nails means no drilling
- Minimum waste
- Maximum ventilation: the clips create an insulating layer between the boards and the internal construction
- Seamless result: boards are automatically aligned

Choose from a range of cladding profiles

Cubus (QuickClip®)



Shiplap (QC®)

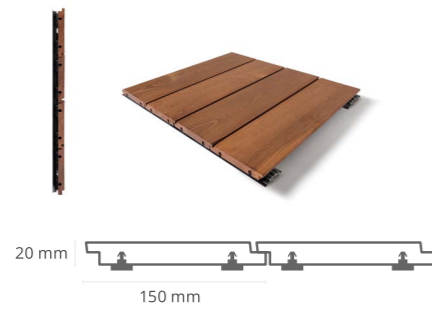

Fine line (QuickClip®)

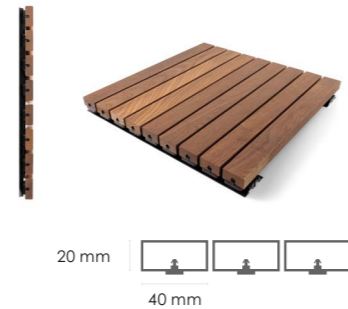

These are just a few of our QuickClip® profiles. To see more, consult our Solutions brochure or visit www.carpentier.be



All fence types are available in:

HOTWOOD ASH



HOTWOOD PINE



HOTWOOD CLEAR PINE

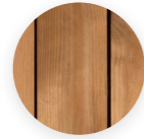

CHARRED WOOD



OAK



BARNWOOD



Wooden fence in charred HOTwood ash, Plus line (QuickClip®)

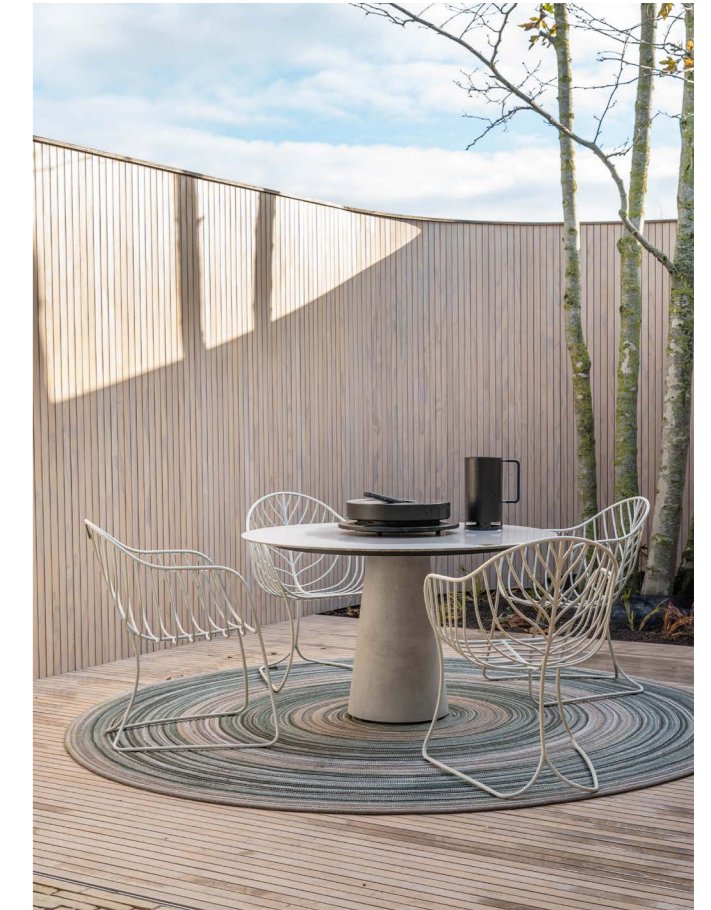

Curved garden fence in HOTwood clear pine Fine line (QuickClip®), oiled with RMC Nude



Timber-frame construction

When it comes to creating made-to-measure prefab elements for timber-frame constructions, Carpentier brings a wealth of know-how and experience to the job. Whether the project is a new-build construction, a renovation or an extension added to an existing home, rapid on-site completion is always assured for timber-frame builders, contractors, carpenters and roofers. Moreover, our app saves valuable time by enabling them to create designs and calculate prices beforehand.

ADVANTAGES OF TIMBER-FRAME CONSTRUCTION

- Strong and durable
- Cost-effective
- Quick construction and shorter time from design and delivery compared to traditional building methods
- Dry construction
- Outstanding insulation value
- Energy-efficient
- Ecologically responsible
- Light construction materials
- Suitable for a range of architectural styles

Quick construction process

Construction of a timber-frame house is much quicker than construction using traditional building methods. See below to find out how Carpentier approaches the construction of a wooden house.



1

An app for designs



2

Automated production in our own workshop



3

Ready-to-assemble construction kit



Extra

Fitting timber cladding in our workshop



4

On-site construction



5

Finishing a timber-frame construction



Extra service: pre-installed cladding

If desired, we can even fit **exterior timber cladding to the prefab walls** at our workshop. This way, assembly on site is simply a matter of 'plug and play'. This extra service means you save even more time on the building site.

Our QuickClip® profiles guarantee a seamless result every time, since cladding boards click into place on the aluminium joists with no visible nails or screws. And because the clips are precisely pre-positioned on the joists, boards are always perfectly spaced.

Read more about our construction process at www.carpentier.be

Timber-frame houses

Timber-frame is becoming ever more widespread in the construction industry. Many developers and architects find it offers numerous advantages both for themselves and for the end client. This very exact, dry construction method can be used in all types of construction: from renovating an existing house to erecting a commercial building or a whole new home.

You can call on us to prepare the plans for your new timber-frame house or bungalow. Our app will help you draw them and calculate costs straight away.

Using our app, the final plans can be sent to the CNC machines in the workshops of our family firm, where we produce all the timber-frame walls to measure, in-house. We also handle the delivery of timber-frame house kits to building sites.

We can even go so far as to deliver the load-bearing structure of the timber construction house ready for assembly, complete with insulation, ductwork for wiring and timber cladding etc.

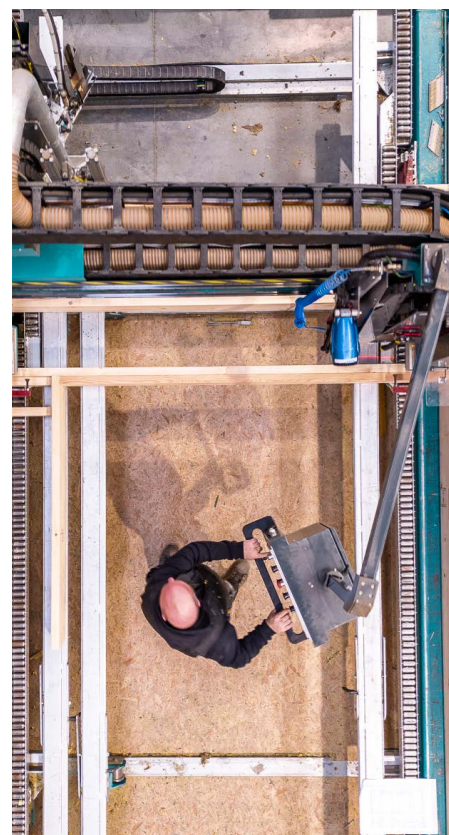

Home extensions

We can also build prefab load-bearing structures for a timber-frame home extension. Carpentier's USP is that we can fit timber cladding to your prefab walls in our workshop. This extra service means you save even more time when building a timber-frame extension.

For an extension in oak, we can provide a fine oak frame combined with roof boards in oak or poplar. Assembling them is also easy thanks to the tongue and groove profiles on two of the four sides.

When it comes to designing your wooden extension, we recommend you use our handy iPad app.



Storey or upward extension

A timber-frame storey or upward extension is a simple way to expand an existing building without the need to use up more ground area. By choosing a timber-frame construction, you can add an extra room or an office in a relatively short space of time.

We make prefabricated elements for timber-frame upward extensions in our workshop and then deliver them to the building site as a timber-frame construction kit. As a wood-build professional or developer, you can thus add an extra storey and have the roof on and windows and doors in very quickly. And since this is a dry construction method, you can get on with fitting interior and exterior finishes straight away.

Why opt for sustainable construction?



Environmentally responsible

In terms of protecting the environment and reducing the ecological footprint of a building, timber-frame construction is the obvious choice. This sustainable construction method results in an energy-efficient home that is supremely comfortable. Besides outstanding thermal insulation, a timber-frame house also offers very good sound insulation. And since timber-frame construction eliminates thermal bridges and renders buildings more energy efficient, their value is also higher. All in all, it should come as no surprise that timber-frame construction has become steadily more popular in recent years.



The strength of wood

The wood that Carpentier uses to create prefab elements is produced sustainably and legally in managed forests. In this way, it contributes to **reducing CO2 emissions**. If desired, we can also apply environmentally responsible wood fibre insulation as the final step in creating a fully sustainable building.

Quick construction and then ready for use

This sustainable building method speeds up construction considerably, an advantage that should not be underestimated. Compared to traditional construction methods, timber-frame construction is much faster all around. There are also **time savings** on site with this dry construction method, since it is not subject to weather-related delays and elements come together as easily as puzzle pieces. The Carpentier app gets things moving quickly from the design and price calculation phase onwards, which means that a timber-frame house can go from start to finish in a **very short space of time**.



Be **inspired** by Carpentier Hardwood Solutions

